

## Trouble Shooting Tips

If your solar light does not come on at dusk despite following all instructions please try the following steps:

1. Make sure that the solar light is not affected by any other light source.
2. Ensure the solar light does not stand in the shade all day.
3. Check to see if the batteries are installed correctly.
4. If there is a protective film on the solar panel carefully remove this.

## Care Information

1. Clean any dirt and debris from the solar panel. The panel cannot recharge if the light is obstructed. Use a soft cloth to clean the panel. Do not use abrasives or chemicals that might scratch or damage the UV coating.
2. In a region where snow and ice are likely and the light assembly is covered with snow for an extended period of time the batteries will require a recharge for at least 8 hours.

## Warranty Information

### 1-YEAR LIMITED PRODUCT WARRANTY

This product is covered under a one year limited warranty. Fusion Products Ltd. warrants to the original purchaser that this product is free from defects in materials and workmanship for the period of one year warranty from date of purchase.

**For Technical Support and/or Warranty inquiries  
please contact:**

**Fusion Products Ltd.**

Monday to Friday

8:30-5:00 PM EST

2905 Argentia Road, Unit 2,3

Mississauga, Ontario L5N 8G6

Tel: 1-877-615-1378 Fax: (905) 812-3256

Email: [sales@fusionproducts.ca](mailto:sales@fusionproducts.ca)



# SOLAR MOTION ACTIVATED SECURITY LIGHT



**FUSION PRODUCTS LTD.**

**Model No. 16908**

# Contents

Overview .....	see below
About Your Solar Light .....	1
Getting Started .....	1
Important .....	1
Parts and Hardware List .....	2
Operation .....	2
Installation .....	3-4
Battery Replacement .....	5
Trouble Shooting Tips .....	6
Care Information .....	6
Warranty Information .....	6

## Overview

This product is designed to the highest technical specifications and standards. It will supply years of maintenance free use. Please read these instructions thoroughly prior to installation, then store in a safe place for future reference. If at any time you are unclear about this product, or require further assistance please do not hesitate to contact our trained professionals operating the customer support line at 1-877-615-1378 Monday to Friday between the hours 8:30 AM to 5:00 PM Eastern Standard Time or email [sales@fusionproducts.ca](mailto:sales@fusionproducts.ca)

## Battery Replacement (Remove Old)

### STEP 1:

Turn the nut on the back of the light by hand in a counter clockwise direction to remove.

### STEP 2:

Carefully remove the back cover of the light.

### STEP 3:

Locate the ON/OFF switch on the lower right hand side. Move the switch to the left (OFF position).

### STEP 4:

Carefully remove the old batteries from the battery compartment.

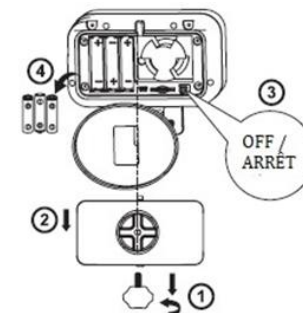

## Battery Replacement (Install New)

### STEP 1:

Replace the batteries with equivalent new solar rechargeable batteries, ensuring the correct polarity is observed.

### STEP 2:

Move the switch to the right (ON position).

### STEP 3:

Replace back cover.

### STEP 4:

Turn the nut in clockwise direction until secure.

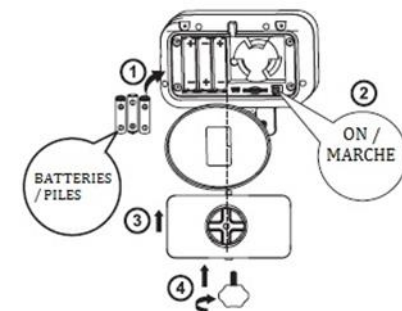

Allow the unit to charge for up to 2 days in the <OFF> position. Once fully charged, move the switch to the right (ON position). The light will automatically come on when motion is detected within the detection zone of the sensor once it gets dark.

**Caution: Rechargeable batteries contain Nickel-Cadmium or Nickel-Metal Hydride and must be recycled or disposed of properly. Do not mix old and new batteries. Do not mix alkaline, standard (carbon-zinc), or rechargeable batteries. Do not dispose of batteries in fire. Batteries may explode or leak.**

## Installation (Remote Solar Panel)

**NOTE:** If you choose, you can mount the solar panel remotely from the light. Follow Steps 1-3 below, and then proceed to "Installation (Mount Remote Solar Panel)"

**STEP 1:** Turn the nut on the back of the light in a counter clockwise direction to remove.

**STEP 2:** Carefully remove the back cover of the light.

**STEP 3:** Remove the screws (2) on the back of the light securing the solar panel to the security light.

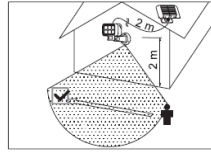

02

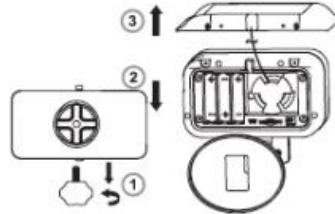

## Installation (Mount Remote Solar Panel)

Carefully pull the wire through the top of security light to the desired length. Before proceeding, ensure you will be able to mount both the security light and solar panel in the desired locations (respectively).

**STEP 1:** Using the mounting bracket as a guide, select desired installation location.

**STEP 2:** Mark the holes where you will need to pre-drill for screws or wall anchors (if required).

**STEPS 3 & 4:** Pre-drill holes for screws and use wall anchors as necessary (if required).

**STEP 5:** Secure screws through corresponding holes in mounting bracket.

**STEP 6:** Line up mounting bracket with the underside of the solar panel.

**STEP 7:** Secure solar panel to mounting bracket with screws.

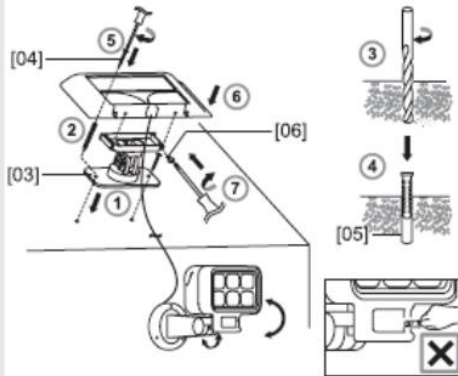
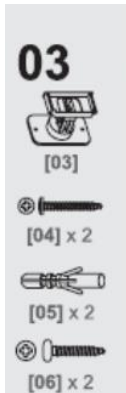

## About Your Solar Light

During the day your solar panel will convert the sun's light and/or UV rays into electrical power that will charge the rechargeable battery. When it becomes dark, the solar light will turn on using the power stored on the rechargeable battery as it will detect no day light. The units light output strength and time depends on how many hours and how much sunlight and/or UV rays your panel absorbs throughout the day.

For maximum output place the solar panel in an area where there is direct sunlight for at least 8 hours in a given day. Do not install your solar light in a shaded area. The selected location should not be near night time light sources such as; porch lights, street lights or pool lights as these may cause the solar light to turn off prematurely.

## Getting Started

Please do not throw away any packing material until all parts are verified as present.

## Important

- Fully charge the battery before first use. Charge under direct sunlight in the <OFF> position for 2 days.
- For best results, locate your solar lamp in a position where it can get direct sunlight on the solar panel and generally free from cover and shade.
- Keep your solar lights away from other night-time light sources, such as streetlights.
- Make sure the solar panels are not covered by dust, snow and debris. Clean it with a soft damp cloth or paper towel periodically. Avoid the use of abrasive cleaning agents.
- Use only rechargeable batteries for your solar lights. Replace with a new battery of the same size each year for optimum performance.
- The performance of the solar light will vary with the time of year. It will deliver more light when it has had a full day in the sun rather than a day in overcast weather.

## Your Solar Light

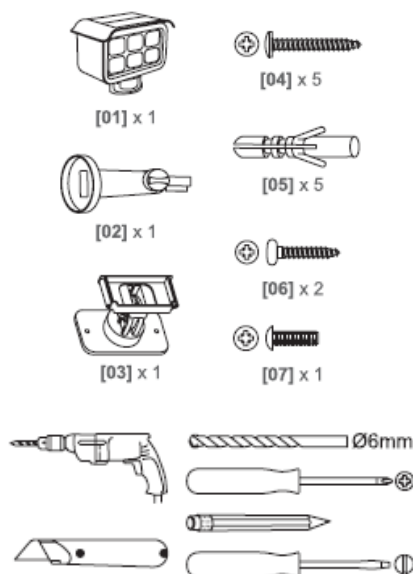

## You Will Need

## Operation

### For First Time Use:

Fully charge the battery before first use. Charge under direct sunlight in the <OFF> position for 2 days.

**STEP 1:** Turn the nut on the back of the light in a counter clockwise direction to remove.

**STEP 2:** Carefully remove the back cover of the light.

**STEP 3:** With the back cover removed, locate the ON/OFF switch on the lower right hand side. Move the switch to the right (ON position). When movement is detected, the light will switch to full power for about 25 seconds, before returning to normal level once again.

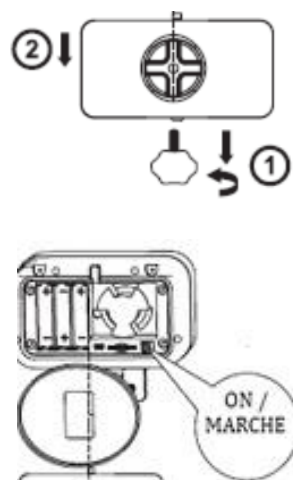

## Installation (Standard Wall Mount)

**STEP 1:** Using the wall mount bracket as a guide, select desired installation location.

**STEP 2:** Mark the holes where you will need to pre-drill for screws or wall anchors (if required).

**STEPS 3 & 4:** Pre-drill holes for screws and use wall anchors as necessary (if required).

**STEP 5:** Secure screws through corresponding holes in wall mount bracket.

**STEP 6:** Line up the hole at the end of the wall mount bracket with the bottom of the security light.

**STEP 7:** Tighten machine screw until secure.

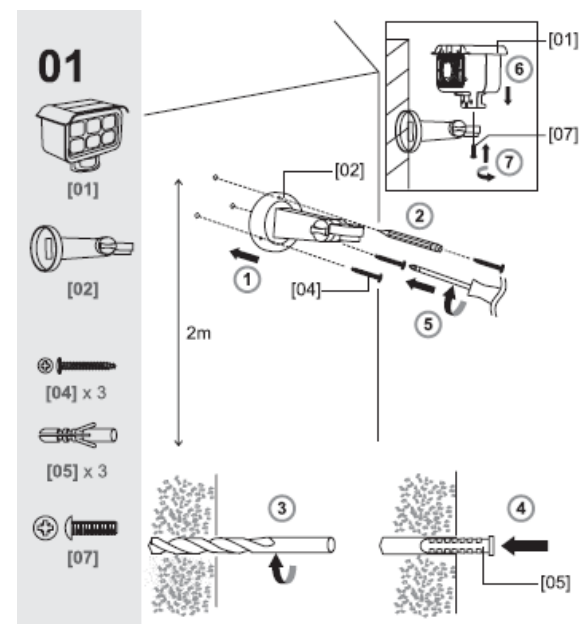

Using the adjustment screw on the side of the wall mount bracket, adjust the angle of the light as required and tighten to secure in the desired position.

